

DESIGN FIRM:
 Ndengu Design, LLC.
 1 Avenue C - Suite 100
 Hudson City, Bayonne County,
 New Jersey 07002-3620
 T: (908) 000-0000
 F: (908) 000-0000
 E: info@ndengudesign.com
 W: ndengudesign.com

CLIENT:
 Buyachi Ndengu Properties, LLC.
 1 Avenue C - Suite 600
 Hudson City, Bayonne County,
 New Jersey 07002-3620
 T: (908) 000-0000
 F: (908) 000-0000
 E: info@ndengu.com
 W: ndengu.com

PROJECT:
 SHAPE REPLICATION
 TO CREATE SPACE
 Hudson Crossing
 Hudson City, Bayonne County,
 New Jersey 07002-3620

CONSULTANT:

CONSULTANT:

CONSULTANT:

CONSULTANT:

CONSULTANT:

CONSULTANT:

CONSULTANT:

CONSULTANT:

CONSULTANT:

CONSULTANT:

CONSULTANT:

CONSULTANT:

CONSULTANT:

CONSULTANT:

CONSULTANT:

CONSULTANT:

CONSULTANT:

CONSULTANT:

CONSULTANT:

CONSULTANT:

CONSULTANT:

CONSULTANT:

CONSULTANT:

CONSULTANT:

CONSULTANT:

CONSULTANT:

CONSULTANT:

CONSULTANT:

CONSULTANT:

CONSULTANT:

CONSULTANT:

1 PHASE J NEIGHBORHOOD PLAN BLOCK 01 055
 G-004.115 SCALE: 1/16" = 1'-0"

3 BLOCK 01 055 - NORTHWEST VIEW
 G-004.115 SCALE: N.T.S

LOT NUMBER	ZONE TYPE	STREET ADDRESS	SQUARE FOOTAGE	NOTES
001	PUBLIC	13-15 AVENUE I NORTH	2298.00	-

2 PHASE J NEIGHBORHOOD - PROPERTY INFORMATION
 G-004.115 SCALE: N/A

4 BLOCK 01 055 - SOUTHEAST VIEW
 G-004.115 SCALE: N.T.S

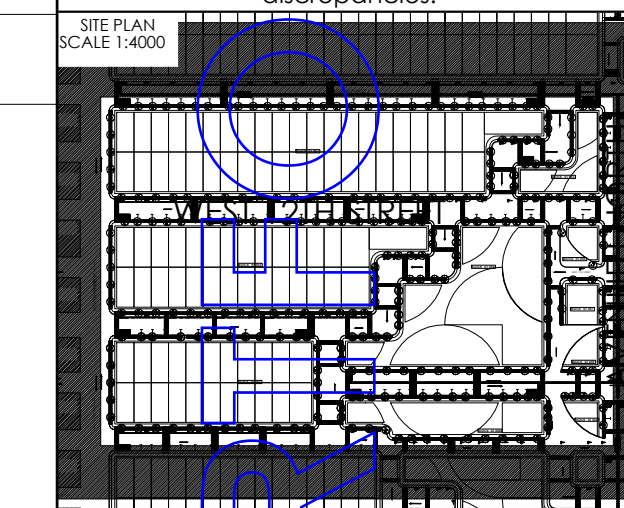

Scale: Drawn By: BN
 Date: 01/09/2020 Checked By:
 PROPERTY & LOT
 NEIGHBORHOOD PLAN
 PHASE J
 BLOCK 01 055
 LOT 001

Project No.
 11001.01
 DWG File Name
 G-004.110.dwg

G-004.115
 Sheet - of Sheets

Copyright © 2020 by Ndengu Design
 All Rights Reserved