

LOT NUMBER	ZONE TYPE	STREET ADDRESS	SQUARE FOOTAGE	NOTES
001	COMMERCIAL	31-35 EAST 9TH STREET	2225.00	-
002	RESIDENTIAL	37-41 EAST 9TH STREET	37158.00	-
003	COMMERCIAL	43-45 EAST 9TH STREET	6507.00	-
004	COMMERCIAL	47-61 EAST 9TH STREET	1904.00	-
005	COMMERCIAL	14-24 AVENUE S SOUTH	8854.00	-
006	COMMERCIAL	46-48 EAST 6TH STREET	2716.00	-
007	COMMERCIAL	38-42 EAST 6TH STREET	2716.00	-
008	COMMERCIAL	32-36 EAST 4TH STREET	1768.00	-

1 BLOCK 01 046 - BLOCK PLAN
G-004.101 SCALE: 1/32" = 1'-0"

2 BLOCK 01 046 - PROPERTY INFORMATION
G-004.101 SCALE: 1/32" = 1'-0"

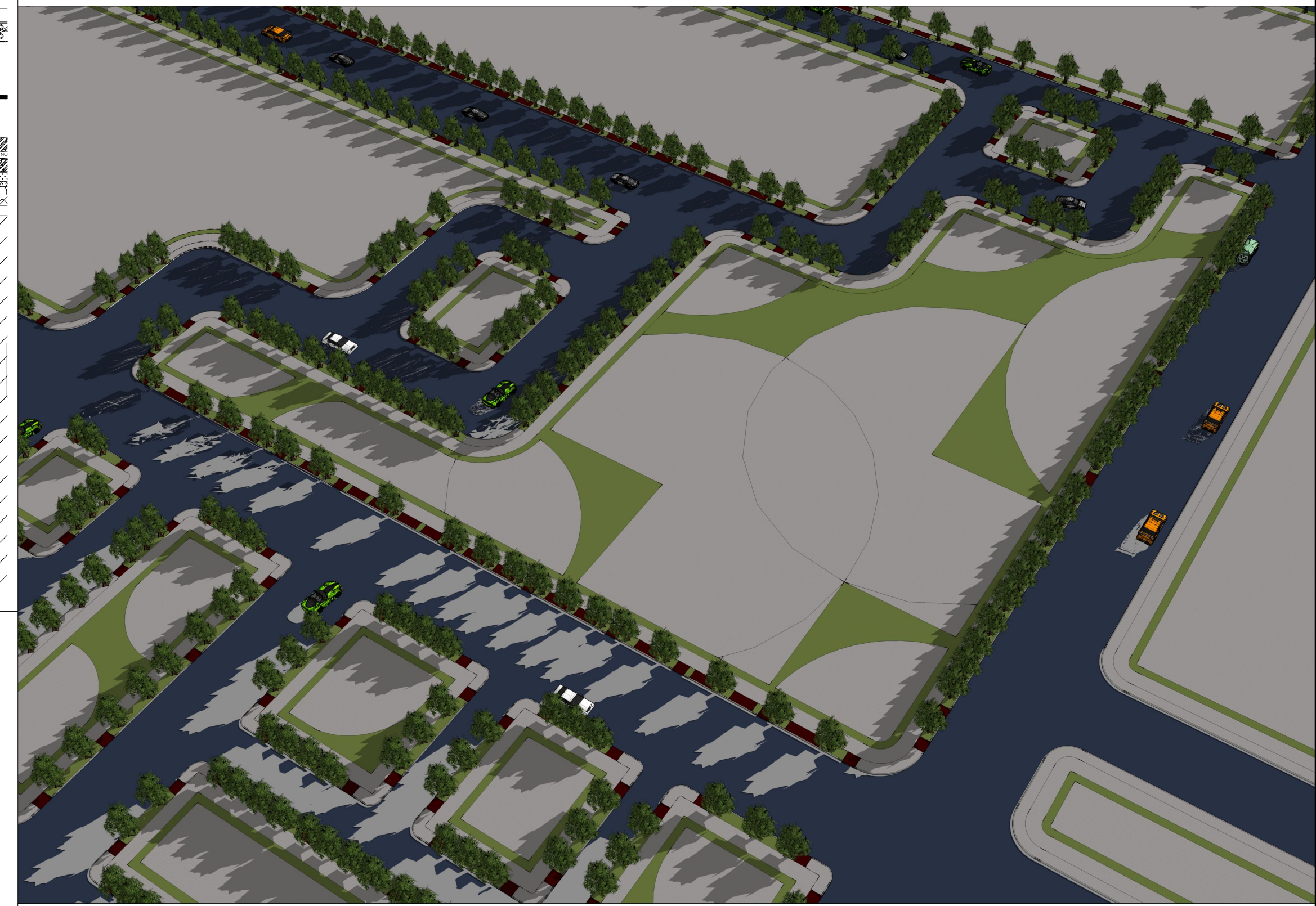

3 BLOCK 01 046 NORTHWEST VIEW
G-004.101 SCALE: N.T.S

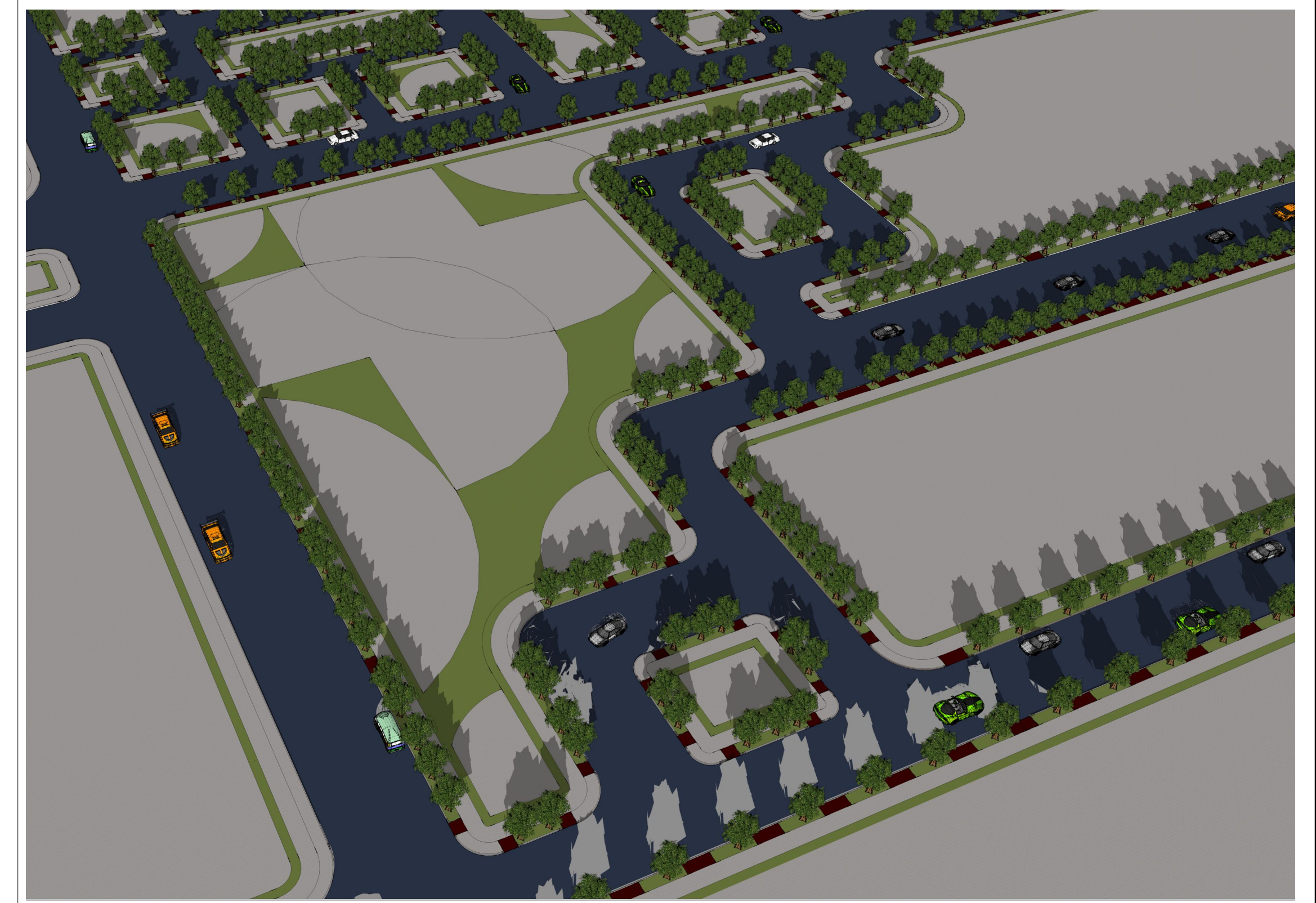

4 BLOCK 01 046 SOUTHWEST VIEW
G-004.101 SCALE: N.T.S

DESIGN FIRM:
Ndengu Design, LLC.
1 Avenue C - Suite 100
Hudson City, Bayonne County,
New Jersey 07002-3620
T: (908) 000-0000
F: (908) 000-0000
E: info@ndengudesign.com
W: ndengudesign.com

CLIENT:
Buyachi Ndengu Properties, LLC.
1 Avenue C - Suite 600
Hudson City, Bayonne County,
New Jersey 07002-3620
T: (908) 000-0000
F: (908) 000-0000
E: info@ndengu.com
W: ndengu.com

PROJECT:
SHAPE REPLICATION
TO CREATE SPACE
Hudson Crossing
Hudson City, Bayonne County,
New Jersey 07002-3620

CONSULTANT:
REVIEW

CONSULTANT:
REVIEW

CONSULTANT:
REVIEW

CONSULTANT:
REVIEW

CONSULTANT:
REVIEW

CONSULTANT:
REVIEW

CONSULTANT:
REVIEW

CONSULTANT:
REVIEW

CONSULTANT:
REVIEW

Scale: Drawn By: BN
Date: 01/09/20 Checked By:
**PROPERTY & LOT
NEIGHBORHOOD PLAN
PHASE H
BLOCK 01 046
LOTS 001-008**

Project No.
11001.01
DWG File Name
A-103.08.dwg

G-004.101
Sheet - of Sheets
Copyright © 2020 by Ndengu Design
All Rights Reserved